



# Orchard Trellising Solutions

For installation, maintenance & repair



- Tension
- Repair
- Anchor
- Brace



# Orchard Trellising Solutions

As market leader in the joining and tensioning of wire, Gripple is renowned for providing innovative, cost-effective solutions for trellising applications. Gripple trellising products replace traditional methods, generating time and labour savings. Our range of products work with a wide variety wires across all types of trellising.



**GP No.1 & No.2**  
Page 5



**GP90**  
Page 9



**Dynamic Range**  
Page 6



**Gripple Plus Range**  
Page 4



**GPAK & DPAK**  
Page 7



**APEX**  
Page 8



**Tools & Accessories**  
Page 10



# Gripple Plus Range

The Gripple Plus range of wire joiners and tensioners is suitable for all trellis applications.

- Join and tension in one
- Features Jumbo, developed specifically for high load applications
- Ideal for use on high tensile and mild steel trellis wire
- Designed for high load holding and corrosion resistance
- Easily re-tensioned year-after-year



Gripple Plus Medium - Used to terminate trellising wire around a wooden post.



Top. Gripple Plus Medium - Wire repair. Bottom. Gripple Plus Medium - Standard join.

Product	Wire Range	Standard Wire Gauge	Maximum Working Load
Gripple Plus Small	1.40 mm - 2.20 mm	17 SWG - 14 SWG	300 kg
Gripple Plus Medium	2.00 mm - 3.25 mm	14 SWG - 10 SWG	400 kg
Gripple Plus Large	3.25 mm - 4.20 mm	10 SWG - 7½ SWG	600 kg
Jumbo	2.50 mm - 3.15 mm	12½ SWG - 10 SWG	600 kg

# GP No.1 & No.2

The Gripple GP No. 1 and No. 2 are designed with a flat leading edge to create a stable end stop for trellises which use metal end posts.

- Terminate and tension in one
- Ideal for use on steel wire and nylon monofilament
- High grade ceramic roller for corrosion resistance
- Spare integral channel allows safe tail wire return
- Tensioned using a Torq Tool and Adaptor in recessed applications



GP No. 1 - Terminating trellis wire at a metal end post.



Adaptor - For use when the tensioner is installed on the inside of the post.

Product	Wire Diameter	Standard Wire Gauge	Maximum Working Load
GP No. 1	1.80 mm - 3.00 mm	15 SWG - 11 SWG	400 kg
GP No. 2	3.00 mm - 4.20 mm	10½ SWG - 7½ SWG	600 kg



# Dynamic Range

The Gripple Dynamic range of fasteners and tensioners is ideal for high load anchoring, structural support and bracing.

- High load performance for safety and security
- Join and tension in one
- Integral lock; one action locks the wire in both channels simultaneously
- High grade ceramic roller for corrosion resistance
- Available in ready to use kits (DPAK) for a fast and secure bracing solution



Dynamic 6 - Post bracing.



Dynamic 6 - Tensioning using Contractor Tool.

Type	Wire Diameter	Maximum Working Load
Dynamic 4	4.00 mm	750 kg
	4.75 mm	1,000 kg
Dynamic 6	6.00 mm	1,750 kg

# GPAK & DPAK

The Gripple Plus Anchor Kit (GPAK) and Dynamic Post Anchor Kit (DPAK) are supplied as ready-to-use kits comprising a pre-cut, fused length of wire rope and a Gripple tensioner.

- Suitable for wooden, metal and concrete post bracing
- Dual brace points for even load transfer
- Easily re-tensioned year-after-year
- Manufactured with zinc aluminium wire rope for corrosion resistance
- Consistent, professional finish



GPAK - Installed in a loop format with choke knot on a wooden post.



DPAK - Installed in a loop format with choke knot on a concrete post.

Product	Kit Contents	Wire Diameter	Wire Length	Max Working Load
GPAK Classic (Wooden Post)	Looped Wire Rope Gripple Plus Tensioner	4.0 mm	5.0 m	600 kg
			6.0 m	600 kg
DPAK 4	Dynamic 4 with Wire Rope	4.0 mm	5.0 m	750 kg
DPAK 6	Dynamic 6 with Wire Rope	6.0 mm	6.0 m	1,750 kg



# APEX

The Gripple APEX Anchor creates a secure, fixed anchoring point below the ground. No pre-digging or ground preparation is required, dramatically reducing installation time.

- Designed for drive efficiency and maximum load capacity
- Streamlined profile for minimal soil disturbance
- Suitable for a variety of soil types
- Speed of installation delivers significant time and labour savings
- Zinc aluminium wire rope for maximum corrosion resistance



APEX anchor seated on Gripple Drive Tool.



APEX anchor being driven into the ground.

Product	Tendon Type	Tendon Length	Corrosion Resistance Rating
APEX 3	Wire Rope (3.00 mm)	0.9 m	++
		1.5 m	
	Rod Tendon (6.00 mm)	0.9 m	+++
APEX 4	Fibre Tendon (4.77 mm)	0.9 m	+++++
		1.5 m	
	Wire Rope (4.00 mm)	0.9 m	++
APEX 5	Rod Tendon (6.00 mm)	0.9 m	+++
		1.5 m	
	Fibre Tendon 4.77 mm)	0.9 m	+++++
APEX 5	Wire Rope (8.00 mm)	1.6 m	++

Load is dependent on the soil quality. APEX is not suitable for hail net structure. Longevity & suitability depends on a variety of factors ask Technical Services for details.

# GP90

Quickly joins and tensions a line wire to a perpendicular boundary cable or bar; ideal for the creation of overhead catenaries for supporting shade cloth and hail netting, or supporting canopy grown and dried on the vine fruits.

- Easier re-tensioning and re-positioning of wires when compared to traditional methods
- High load capability can handle heavy crops and resist wind/hail damage
- Eliminates tying and knotting, ideal for high tensile steel wire
- Compatible with existing Gripple tensioning tools



GP90 on fruiting wires.



GP90 - Tensioning using Gripple Torq Tool.

Product	Boundry Cable / Bar Range	Cross Wire Range	Maximum Load
GP90	6.0 mm - 16.0 mm	1.8 mm - 4.0 mm	600 kg



# Tools & Accessories

## Gripple Petrol Driver



The Gripple Petrol Driver provides quick installation of trellis posts and Gripple's APEX range. Weighing only 15 kg, it is lightweight and portable.

## Gripple Drive Tool

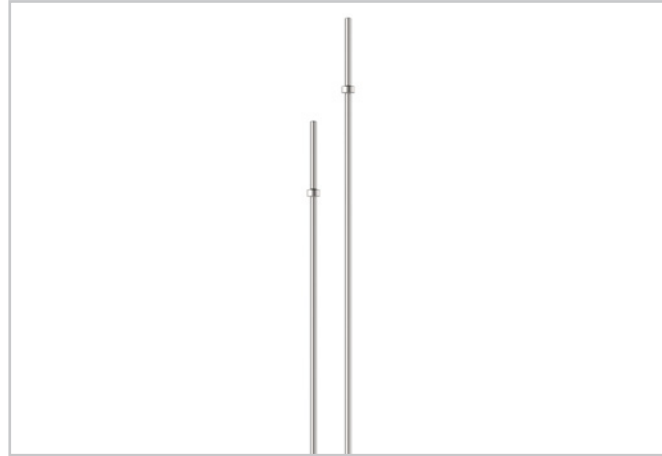

The Gripple Drive Tool is designed specifically to work with Gripple's APEX range. The tools are available in 1.5 m and 1.8 m lengths dependent on the depth of the ground anchor installation. The collar ensures easy removal after installation, even in tough ground conditions.

## Concrete Post Kit



The Gripple Concrete Post Kit is the complete solution to quickly and securely fasten trellis wires to all sizes of concrete end posts. Comes as a ready-to-use, with a Gripple Medium and 1.2 m length of wire rope.

## Twister



The Twister secures the tail wire. Making the installation completely safe and hazard free, it gives a tidy and neat finish. Use on mild steel or high tensile wire from 1 mm to 3 mm.

## Contractor Tool



The all-metal Contractor Tool is strong, robust and built to withstand everyday wear and tear. Tension is easily applied to Gripple tensioners on up to 6 mm wire.

## Torq Tool & Adaptor



The Torq Tool is lightweight, compact and tensions up to 6 mm Gripple tensioners. Designed with an in-built gauge, the tool measures the tension you wish to apply. The Torq Tool Adaptor provides extra reach, allowing for easy tensioning of GP1 and GP2 when installed inside a recess. This is useful where a metal end post is installed with the inside facing out of the row.

## JackJaw® & Anchor Setting Tool



The JackJaw® is a multifunctional tool, allowing for easier extraction of Gripple Drive Tools in hard ground. It can also be used for the load locking of ground anchors when used in combination with the Anchor Setting Tool.

## Setting Key



The Setting Key allows Gripple tensioners to be repositioned on the wire before tension is applied. To use, simply insert the key into the small hole adjacent to the main channel, releasing the roller and allowing the tensioner to move freely.

## Wire Cutters

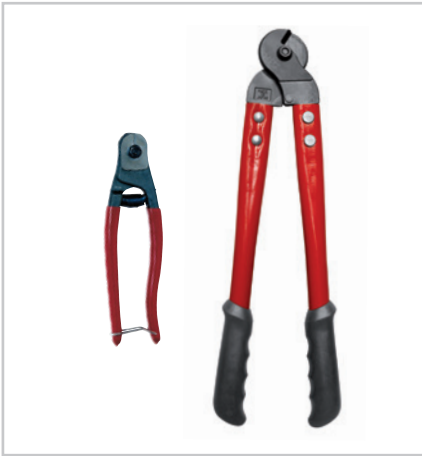

The Wire Cutters are suitable for cutting high tensile wire or wire rope. Available in two sizes: up to 4 mm diameter and up to 6 mm diameter.

## Work Belt



The Gripple Work Belt is the perfect accessory for carrying your Gripple products and your vineyard tools.



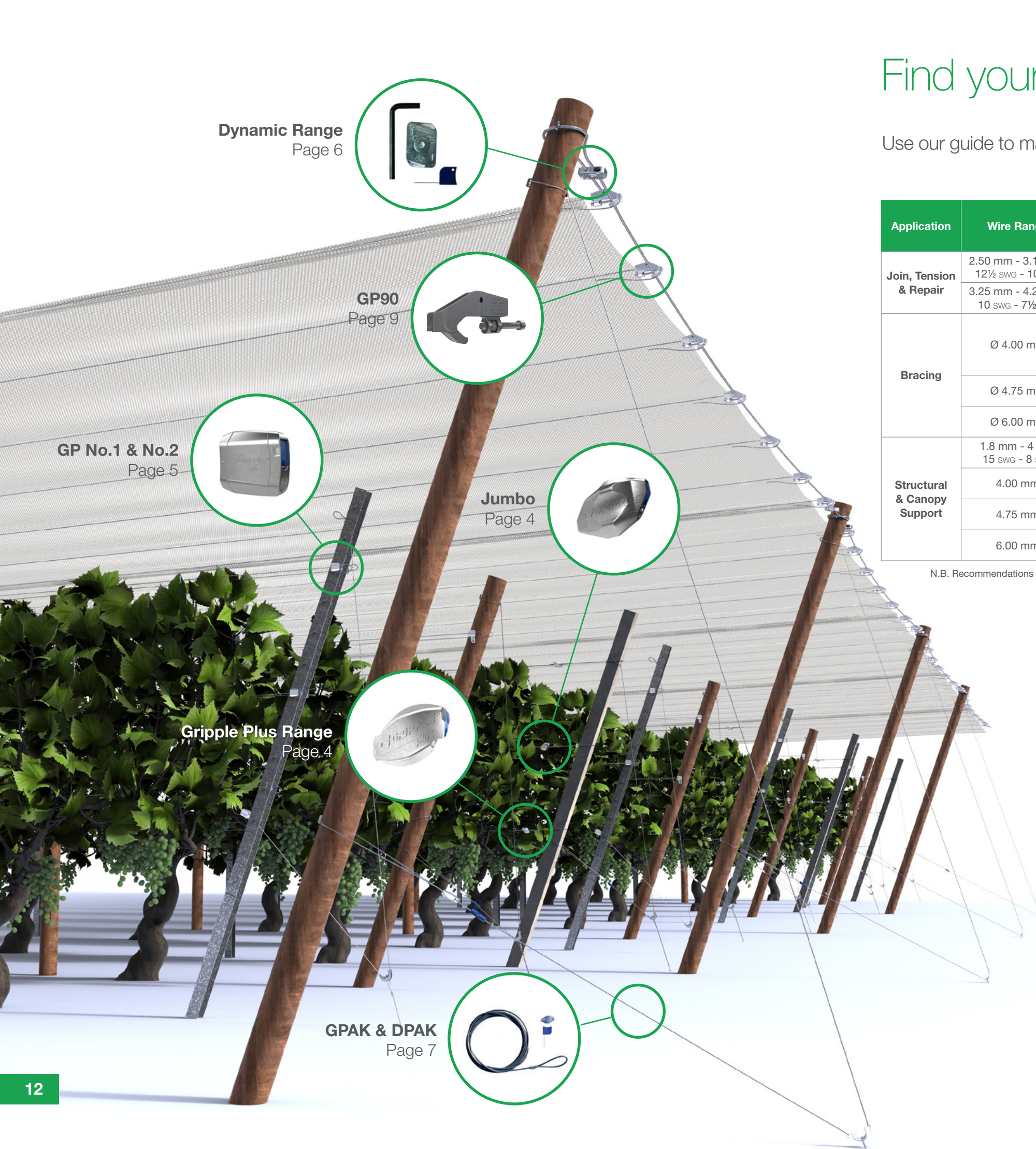

**Dynamic Range**  
Page 6



**GP90**  
Page 9



**GP No.1 & No.2**  
Page 5



**Jumbo**  
Page 4

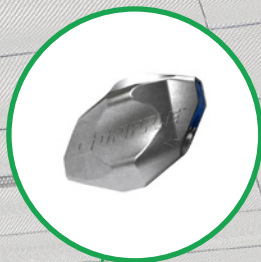

**Gripple Plus Range**  
Page 4



**GPAK & DPAK**  
Page 7



## Find your wire solution

Use our guide to match your wire with the correct Gripple product.

Application	Wire Range	Jumbo	Gripple Plus Large	Dynamic 4	Dynamic 6	GPAK Classic	DPAK 4	DPAK 6	GP90	Maximum Working Load
Join, Tension & Repair	2.50 mm - 3.15 mm 12½ SWG - 10 SWG	✓								600 kg
	3.25 mm - 4.20 mm 10 SWG - 7½ SWG		✓							600 kg
Bracing	Ø 4.00 mm		✓			✓				600 kg
				✓			✓			750 kg
	Ø 4.75 mm			✓						1,000 kg
Structural & Canopy Support	Ø 6.00 mm				✓			✓		1,750 kg
	1.8 mm - 4 mm 15 SWG - 8 SWG								✓	600 kg
	4.00 mm			✓						750 kg
	4.75 mm			✓						1,000 kg
	6.00 mm				✓					1,750 kg

N.B. Recommendations are based on typical installations. Longer rows, heavy crops or exposed areas may require a different product. Seek advice first.



# Technical Advice & Installation

## Gripple Plus Range (featuring Setting Key adjustment)

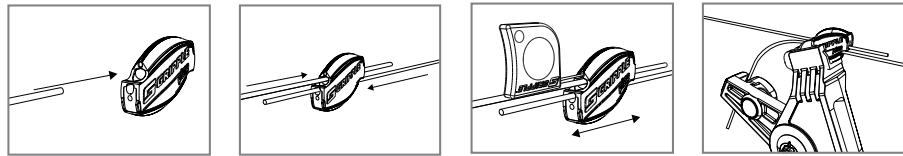

- Apply and re-apply tension with a tensioning tool (leave at least 75 mm tail wire)
- Reposition before applying tension using a Setting Key

## GP No. 1 & No. 2 - Installation

## Adaptor (inside metal post)

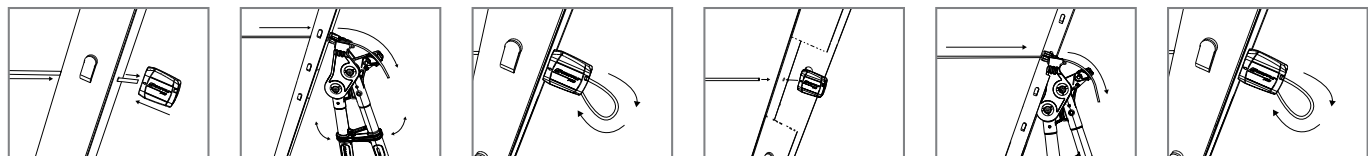

- If the post is installed 'open-side-out', there is a handy adaptor that can be fitted to the tool to make tensioning easier

## Dynamic Range

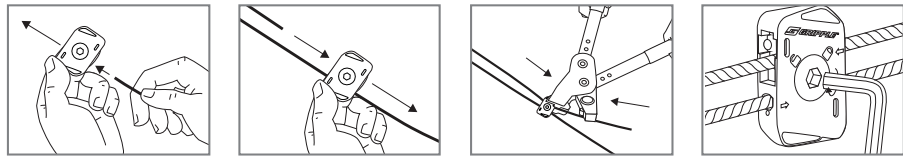

- Use hex key supplied to lock both channels simultaneously
- Unlock and re-tension without releasing the load

## GPAK/DPAK

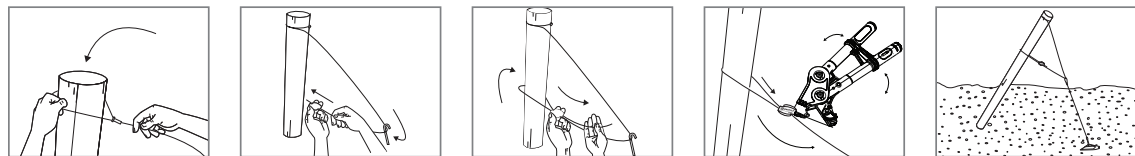

- Combine with an Anchor for a complete anchoring solution that's simple and fast to install.

## APEX

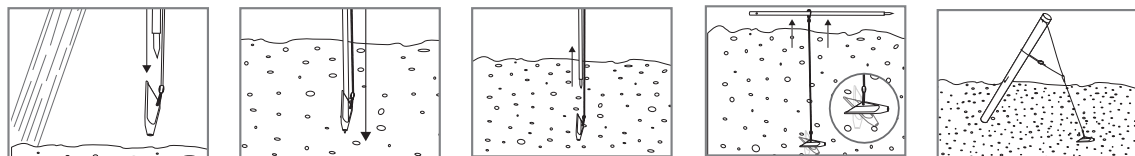

- Always drive the APEX anchor fully into the ground, to depth of at least 1 m
- For even quicker installation of Gripple's APEX, use the Gripple Petrol Driver

## GP90

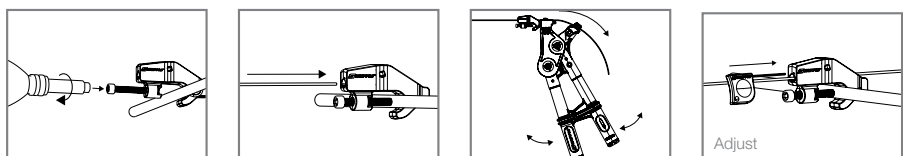

- Use a cordless drill with extended 5 mm hex drive bit to quickly install the product
- Do not apply full tension to cross wires, to allow for additional crop lod or wind lift

## Concrete Post Kit

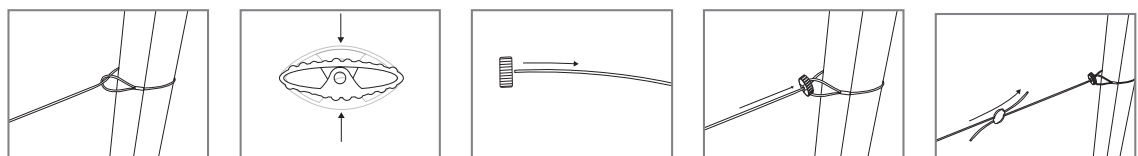

- Position collar tight to post to secure
- Apply tension with a tensioning tool

## Twister

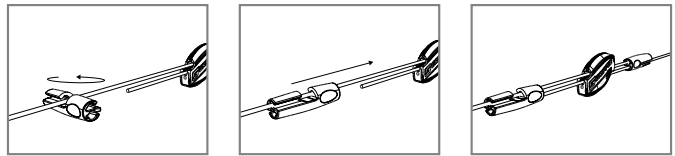

- A Twister tidies tail wires and can be removed and re-attached to allow for re-tensioning

## Torq Tool

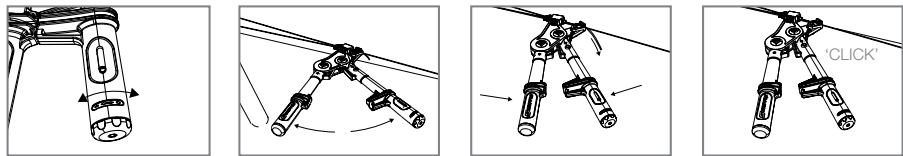

- Never tension above the wire manufacturer's recommendation

## Contractor Tool

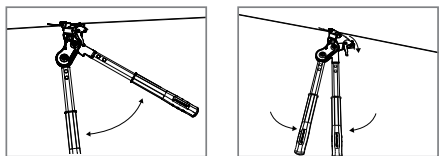

- Never tension above the wire manufacturer's recommendation



**www.gripple.com**  
info@gripple.com

**Gripple Ltd (Headquarters)**

The Old West Gun Works  
Savile Street East  
Sheffield S4 7UQ  
UK

**T** | +44 (0) 800 018 4264

**F** | +44 (0) 114 275 1155

**E** | info@gripple.com

**Gripple Europe SARL**

1, rue du Commerce  
BP 37  
67211 Obernai Cedex  
France

**T** | +33 (0)3 88 95 44 95

**F** | +33 (0)3 88 95 08 78

**E** | frinfo@gripple.com

**Gripple Inc**

1611 Emily Lane  
Aurora  
IL 60502  
USA

**T** | +1 866 474 7753

**F** | +1 800 654 0689

**E** | grippleinc@gripple.com

**Gripple India**

C-115, Industrial Area  
Phase I, Naraina  
New Delhi-110028  
India

**T** | +91-11-45136817

**F** | +91-11-45136817

**E** | ininfo@gripple.com

**Gripple Canada Inc**

6665 Tomken Road  
Units 9-10  
Mississauga, ON L5T 2C4  
Canada

**T** | +1 905 458 8700

**E** | cainfo@gripple.com

**Gripple Japan K.K**

2-57 Tsukizi-cho  
Hyogo-ku, Kobe-shi  
Hyogo, 652-0845  
Japan

**T** | +81 (0) 78 681 2121

**F** | +81 (0) 78 681 2122

**E** | japan@gripple.com



A GLIDE company



**VOF-BROC-VOF-ENG-2706**

Published June 2020

Please refer to [www.gripple.com](http://www.gripple.com) for  
the most up to date user advice and  
product information.



© 2020 Gripple.

Gripple is a registered trademark of Gripple Limited.  
Company registered in England No. 1772901, VAT Reg No. GB 600 1951 88